

3.4.2.1. TOOLS for Revit

FREE

TOOLS for Revit (T4R) FREE allows you to classify a BIM model, divide it into sections according to the construction working plan, mark and export completed elements on the construction site, and categorize non-modeled types of work as completed items.

You can download plugins by following the **link** after registering on the **SIGNAX** service.

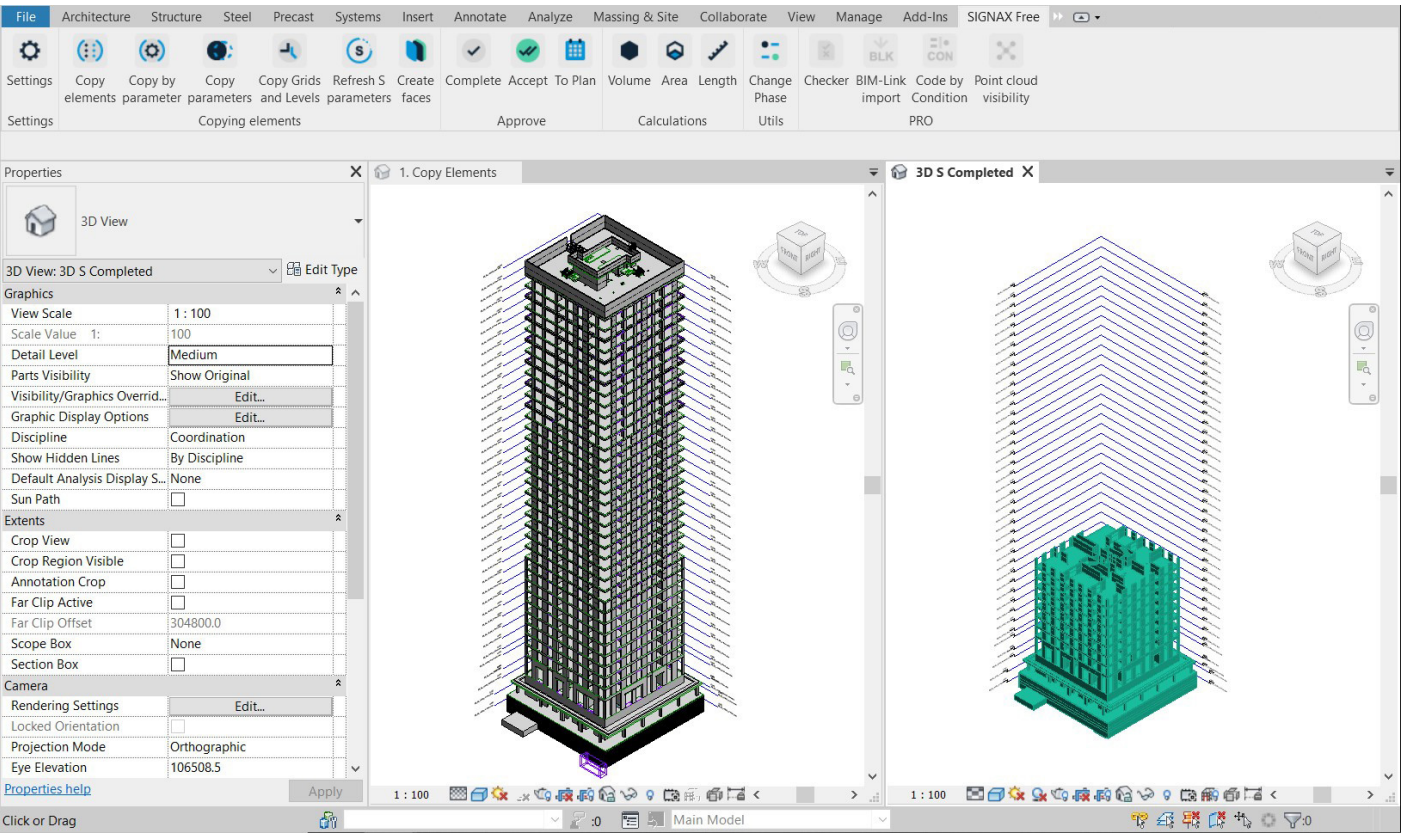

Tools	Description
Copy elements	Copying elements and their parameters from the linked Project model to create a Construction model.

Copy by parameters	Copying elements from the linked Project model to the Construction model based on key parameters such as Floor, Type, etc.
Copy parameters	Independently copying parameters of elements from the linked Project model to the Construction model.
Copy grids and levels	Copying Axes and levels from the linked Project model for more convenient work in the Construction model.
Complete	Assigning a date of actual completion on the construction site to an element, specifying the performer and type of work.
Accept	Assigning a date for coordination or payment according to invoice to an element, specifying the performer and type of work.
To plan	Assigning a planned completion date on the construction site to an element, specifying the performer and type of work.
Volume/Area/Length	Obtaining numerical characteristics (Volume, Area, Length) of a model element.
Create faces	Creating surfaces along the edges of an element with selected material, thickness, etc., intended for the creation of multi-layer facades or interior finishes when those are represented as single-layer walls or not modeled at all.
Change phase	Switching an element's status from "Design" to "Completed" to display the progress of work in views.
Refresh S parameters	Updating numerical parameters (Surface Area, Volume, Length) and Surface ID history for elements in the "Parts" category. This is required when the geometry of an element is modified.

The algorithm for creating and managing a Construction model.

Managing a Construction model in Navisworks

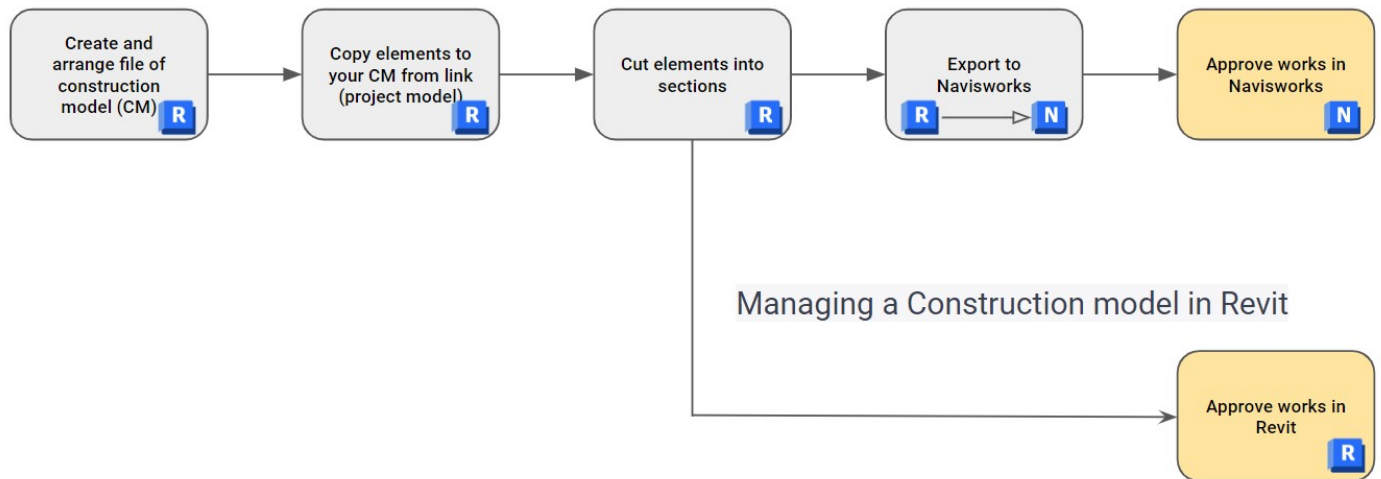

Managing a Construction model in Revit

Revision #5

Created 5 October 2023 05:55:54

Updated 7 May 2024 12:27:29 by SIGNAX SUPPORT